

A Special Employee

We all learned about history in school, how Champlain sailed up the St. Lawrence River and established Quebec City, about the Vikings on Canada's East Coast and about the battle on the Plains of Abraham. We know that many came before us and they have made our current lifestyles possible. As Warren Buffet said "someone is sitting in the shade today because a long time ago someone planted a tree".

Something that we often don't think about is that history is not

necessarily always what actually happened but may instead be what we thought happened. That is because our actions are based on our own perception, not always on the facts. For example, my father tells me he walked seven miles to school, up hill both ways!

When I look at the history of Thompson Electric, there are a lot of memories. I remember **Ernie Eaton** coming to work on Saturday mornings, pumping gas and doing oil changes. I remember **Peter Roantree** driving a

1962 purple Dodge Valiant to work at Troy Manufacturing with a ladder strapped to the roof. I remember hearing about **Glen Webb** being forgotten on a job in Burnt Hills and then finding an old pair of bob skates in the shed and skating down the lake home. There are hundreds, if not thousands of stories...some funny, some not so funny...that make up the history of Thompson Electric.

All of us at Thompson Electric make history everyday. We

(Continued on page 9)

Inside This Issue

- Collaboration & Teenage Sex
- "Paradox of Our Time" - George Carlin
- Christmas Party Information
- Where Will the Jobs Come From?
- New Puzzle and Contest
- "Groaner Corner"

www.thompsonelectric.ca
enquiries@thompsonelectric.ca
Phone: 613-387-3200



Financial-Where will the Jobs Come From?

“The more things change, the more they stay the same”. This statement could not be more true than in the world of electrical contracting. Electricity has been the mainstay of our home and industry. From the distribution of hydro throughout the Ontario countryside, replacing the old Delco generating sets, bringing inexpensive, safe and efficient power to rural farms, to the installation of giant windmills and fields of solar panels to convert energy into usable power.

Thompson Electric has had the opportunity to be involved in completing a number of these projects. In the 1940’s we began by building some of the rural lines and today we are involved in creating alternative energy sources.

Thompson Electric has had the opportunity to be involved in a number of these new and exciting projects over the last year. Most recently, we assisted Brent Bolton Electric in the electrical connections of a 500 kW methane powered generator at Ledgecroft Farms owned by the Green family. This project involves the collection of cow

manure, processing it through a pasteurizer and then combining it with other organic waste to be converted to methane gas through an anaerobic digester. This state-of-the-art system will produce 500 kW of electrical energy to be sold back to Hydro One. This will help to ease the strain on our generating systems in Ontario.

In July and August we had crews working on Canada’s largest solar farm, The Stone Mills Project in Napanee. This farm utilizes 126,000 solar panels over 90 acres to generate 10 million kilowatt hours of renewable electricity in its first year. In March we supplied crews to help with the electrical connections of the giant windmill project on Wolfe Island This project consists of 86, 2.3 MW, wind turbines. With a nameplate capacity of 197.8 MW, it is presently the second largest wind installation in Canada. The facility achieved commercial operation on June 26, 2009 and we can now watch the wind mills turn from Kingston.

All this new technology should not seem too surprising to our customers and staff. Even 25 years



ago, Thompson Electric was working with leading edge companies such as Honeywell and Square D installing peak load controllers and energy management systems in schools, restaurants and high rise apartments. Our crews also set up and installed huge capacitor banks to allow industries such as Alcan run their operations more effectively with safe and dependable electrical

energy. We have worked on Co-Gen and many other systems to both produce and utilize electrical energy to our clients, as well as keep in mind the environmental effects. As recently as 2005, we developed and presented a series of talks on the wise use of electricity and other forms of energy in our "Leaks" program. This was designed for homeowners, apartment dwellers and trades people.



What can come next? Whatever it is that comes next, you can bet it will involve the generating and distribution of electrical energy.

I can safely say that the people that supply, install and service electrical systems will always have a job to do. And **Thompson Electric** will always be in the market for new and innovative systems that improve the efficiency and reliability of one of Ontario's greatest resources. 

Collaboration and teenage sex

The subject of collaboration was explored in depth by Dr. Nick Bontis at an industry conference this past summer. He's a strategy and management expert, and his session dealt with intellectual capital and knowledge management. He's also associate professor of strategy at McMaster University, so he's knows a little something about the next generation coming through our schools.

One of the things the next generation does very well - almost to a fault, actually - is collaborate, something that long-established industry players like ourselves do very poorly. So poorly, in fact, that Bontis likened our collaboration efforts to teenage sex. Here's how:

- Everyone thinks everyone else is doing it.
- No one is sure what it is, but they hear it's

great.

- Those who say they are doing it are probably lying.
- The few who actually are doing it are probably not doing it well.

And the number one reason collaboration is like teenage sex...

- The reality is that when you finally do it, you are never satisfied.

Collaboration, however, is the key to success in the new world. No one can be expected to know everything, which is why we need to continuously tap each others' resources to maintain our com-

(Continued on page 8)

THE PARADOX OF OUR TIME

By: George Carlin

The paradox of our time, in history is that we have taller buildings, but shorter tempers; wider freeways, but narrower viewpoints. We spend more, but have less; we buy more, but enjoy it less. We have bigger houses and smaller families; more conveniences, but less time; we have more degrees, but less sense; more knowledge, but less judgment; more experts, but more problems; more medicine, but less wellness.

We drink too much, smoke too much, spend too recklessly, laugh too little, drive too fast, get too angry too quickly, stay up too late, get up too tired, read too seldom, watch TV too much, and pray too seldom.

We have multiplied our possessions, but reduced our values.
We talk too much, love too seldom, and hate too often.

We've learned how to make a living, but not a life; we've added years to life, not life to years.

We've been all the way to the moon and back, but have trouble crossing the street to meet the new neighbour.

We've conquered outer space, but not inner space. We've done larger things; but not better things.

We've cleaned up the air, but polluted the soul.

We've split the atom, but not our prejudice.

We write more, but learn less.

We plan more, but accomplish less.

We've learned to rush, but not to wait.

We build more computers to hold more information to produce more copies than ever, but have less communication.

These are the times of fast foods and slow digestion; tall men, and short character; steep profits, and shallow relationships.

These are the times of world peace, but domestic warfare; more leisure, but less fun; more kinds of food, but less nutrition.

These are days of two incomes, but more divorce; of fancier houses, but broken homes.

These are days of quick trips, disposable diapers, throw-away morality, one-night stands, overweight bodies, and pills that do everything from cheer, to quiet, to kill. It is a time when there is much in the show window and nothing in the stockroom; a time when technology can bring this letter to you, and a time when you can choose either to share this insight, or to just hit delete.

Bulletin 26-23-0

Receptacle requirements in kitchens of dwelling units

Rule 26-712 (d)

Issued May 2009

Scope

Receptacle for kitchen peninsula

Question 1

Does a receptacle mounted on the wall above a kitchen counter adjacent to a kitchen peninsula satisfy the requirement for the peninsula receptacle?

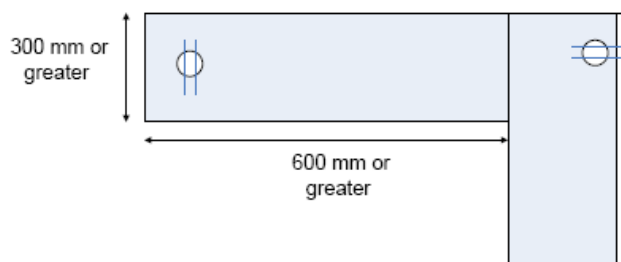

Answer 1

No. Diagram B1 requires a receptacle to be installed on the peninsula as shown.

Diagram B1 – Receptacle mounted on the wall does not satisfy the requirement for the peninsula receptacle

Question 2

Does a receptacle mounted on the wall above a standalone kitchen counter peninsula satisfy the requirement for the peninsula receptacle?

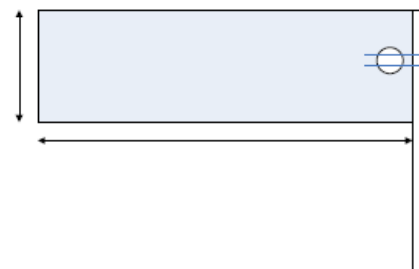

Answer 2

Yes. Diagram B2 is code compliant.

Diagram B2 – Receptacle mounted on the wall satisfies the requirement for the peninsula receptacle

Rationale for Answers 1 and 2

The answers are based on the kitchen peninsula design.

- If the kitchen peninsula is stand alone, with a long dimension of 600 mm or greater and a short dimension of 300 mm or greater and is attached to the wall, then a receptacle on the wall meets the requirement of 26-712(d) (v).

- If the kitchen peninsula with a long dimension of 600 mm or greater and a short dimension of 300 mm or greater is attached to the kitchen counter, then a receptacle on the wall does not meet the requirement of 26-712(d) (v)

Groaner Corner

Did you hear the one about the man who opened a dry-cleaning business next door to a convent?

He knocked on the door and asked the Mother Superior if she had any dirty habits.

A neutron goes into a bar and asks the bartender: How much for a beer? The bartender replies: For you, no charge.

A ship carrying blue paint collided with a ship carrying red paint. The crew are believed to be marooned.

How do you get holy water? Boil the hell out of it.

Transvestites are men who like to eat, drink, and be Mary.

Why aren't fishmongers generous? Their business makes them selfish.



"Hi, honey... I'm Ohm!"



NEVER CATCH SNOWFLAKES
WITH YOUR TONGUE
UNTIL ALL THE BIRDS
HAVE GONE SOUTH
FOR THE WINTER.

Notice to Electrical Apprentices

team

Thompson Electric Apprenticeship Meeting

Over the next month we will be visiting the various sites to meet with the apprentices on each job to discuss what the company can do to help the apprentices do their job better .

The other items on the agenda will be to make available information to the apprentices on how to collect various government rebates and tax incentives.

We feel that through involving apprentices in the day to day activities of operating the company, they will not only enjoy their work more, but will help all of us do our job better.

It is our hope that through this series of meetings, we will arrive at a regular meeting every three months or so to continue the dialogue between apprentices and management, and to make available both additional training and information to better provide first class service and product for our clients.

“Collaboration” (Continued from page 3)

petitive advantage.

The world is constantly changing and evolving, yet our systems, procedures and attitudes languish in antiquity. Take a look at our education system, Bontis said, by way of example: a four-year bachelor degree *hasn't changed in 500 years!* Our education system is simply not keeping pace with technology and the needs of the market.

The job of accounting also hasn't changed in hundreds of years, Bontis explained, which is why we

still put "Training" under the "Expenses" column in our balance sheets, when it should be treated *as an investment*.

Remember these points when next you or your employees are faced with the opportunity to advance your skills and expand your company's knowledge base. These opportunities, along with chances for collaboration, should be welcomed, not shunned. It's only a matter of time before the mantra "This is the way we've always done things" won't cut it any more.

(excerpt from *Electrical Business*, Sept. 2008)

Here are the Answers to Last Month's Crossword Puzzle



Fall Protection

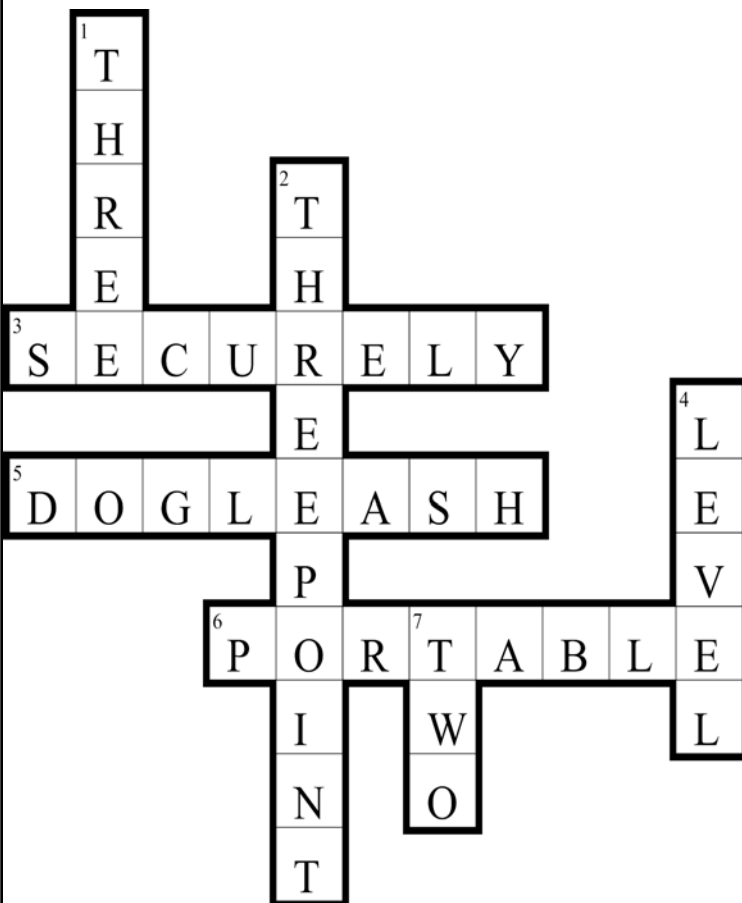

Across

3. Protective floor coverings must be _____ fastened down.
5. _____ is another name for a retractable lifeline.
6. Most common ladders used in construction are _____.

Down

1. Extension ladder must extend _____ feet above a platform.
2. Ladder users must maintain _____ contact
4. PEWP's must always be operated on a firm _____ surface.
7. Warning barriers and bump lines should be set up around the work area at least _____ metre(s) from unprotected edge.

Created with EclipseCrossword - www.eclipsecrossword.com

“Employee” (Continued from page 1)

work on projects, big and small, we work with complicated circuits and with thumb-crushing, knee-banging jobs that involve hammering our way through reinforced concrete. We get to know our co-workers by sharing some of our stories from the past. It is all in a day’s work.

Our office is as important as the field. Over the years I have had

the opportunity to work with some very dedicated and talented people. Names like **Jack Wyatt, Herb Eaton, Joyce Fleming, Penny Roantree and Linda Stanford**. All of these people are the ones that actually wrote most of the factual history of Thompson Electric. They recorded what we did in financial statements, government reports, accounts payable and pay cheques.

In our entire history of 63 years, no one has done the job any better or with anymore dedication than **Linda Stanford**. Linda’s qualifications are numerous; so many that I could not possibly list them all here. **Linda** has had a lasting impact on Thompson Electric over the last **25 years** and it is my perception that Thompson Electric would not have been able to rise to it’s level of success without her. 

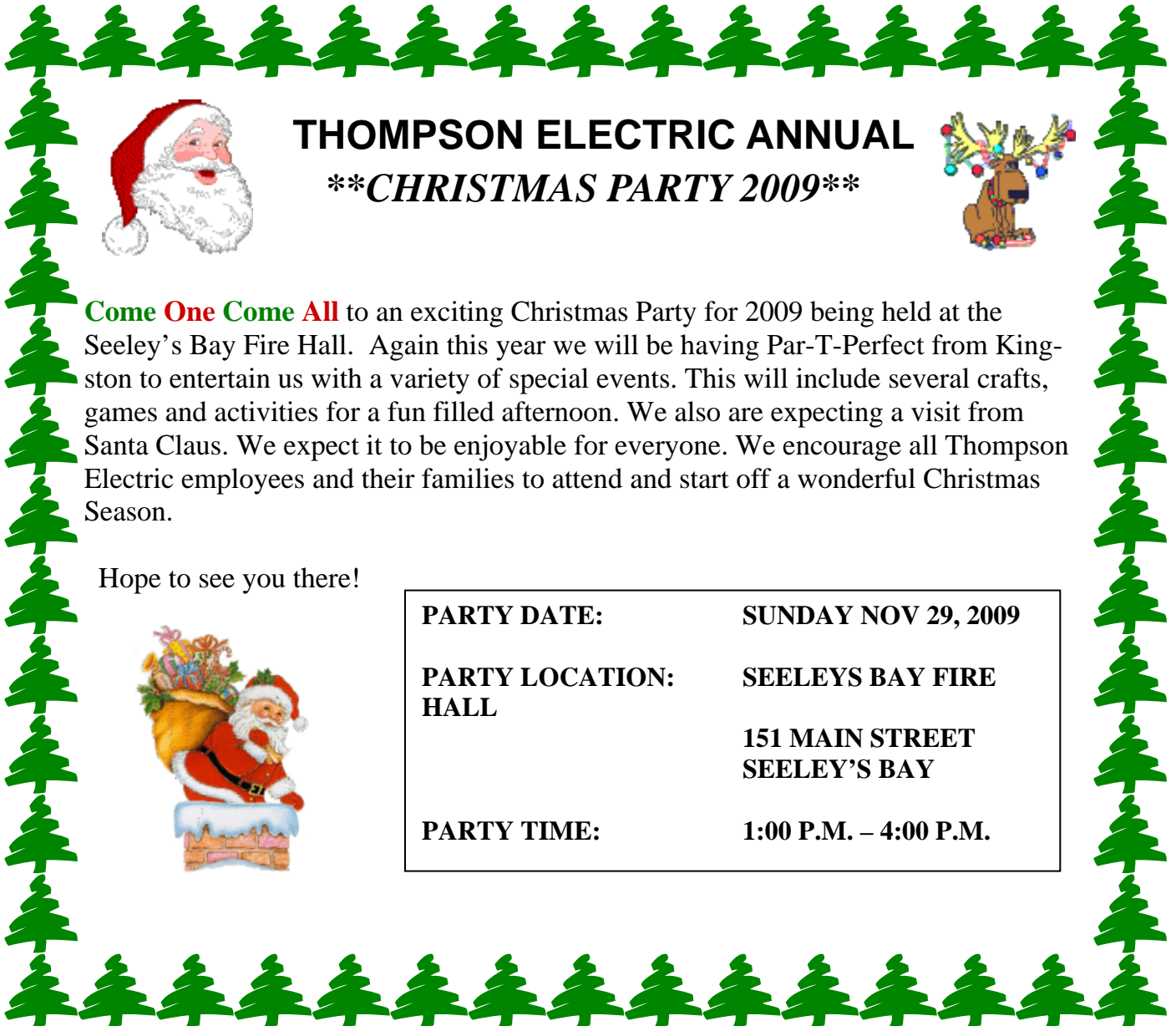

THOMPSON ELECTRIC ANNUAL
****CHRISTMAS PARTY 2009****



Come One Come All to an exciting Christmas Party for 2009 being held at the Seeley’s Bay Fire Hall. Again this year we will be having Par-T-Perfect from Kingston to entertain us with a variety of special events. This will include several crafts, games and activities for a fun filled afternoon. We also are expecting a visit from Santa Claus. We expect it to be enjoyable for everyone. We encourage all Thompson Electric employees and their families to attend and start off a wonderful Christmas Season.

Hope to see you there!



PARTY DATE:	SUNDAY NOV 29, 2009
PARTY LOCATION:	SEELEYS BAY FIRE HALL
	151 MAIN STREET SEELEY’S BAY
PARTY TIME:	1:00 P.M. – 4:00 P.M.

2009 Thompson Electric Golf Tournament



LATEST CONTEST WINNERS

Congratulations to Ernie Eaton, Mark Trachy and Adam Roantree.

Each wins \$50 CASH after being randomly drawn from all the correct entries from the last contest.

The correct answer was—
"THREE POINT"

Thanks to everyone who entered.

Check out page 11 for this issue's contest details and your new chance to win \$50 CASH.

YOU COULD WIN \$50 CASH!

ANSWER THE FOLLOWING QUESTION FOR YOUR
CHANCE TO WIN:

**What is the correct answer
for question #2 in the cross-
word puzzle on Page 12?**

Winning is easy. Just **email, call or drop
off** your answer to the office. Three
winners will be randomly drawn from the
correct entries.

Phone: 613-387-3200

Email: enquiries@thompstonelectric.ca

*This contest is limited to employees of Thompson
Electric only. One entry per employee.*

Never worry about the size of
your Christmas tree. In the eyes of
children, they are all 30 feet tall."
~ *Larry Wilde, author 'The Merry
Book of Christmas'*.

IN THE NEXT



- *Jobs of the Future*
- *2009 Industry Conference Photos*
- *Trade Organization & You*
- *Work in Progress - 2010 Customer
List*

No One Listens...Yes we do!!

Thompson Electric has a history of implementing changes to procedures that field electricians have recommended. We know that we all win when suggestions come from people on the job. We also know that you like to be recognized for your suggestions. So, the hat program is back for original suggestions. If you help to implement your suggestion, you and a guest go to dinner on Thompson.

**Please fill in your suggestion for improvement below or email to us at:
enquiries@thompstonelectric.ca**

My Suggestion is: _____

Name: _____

Job Site: _____ **Date:** _____



Back to the Books

Ryan Boyce and **Joel Dijkema** are currently attending **Trade School** at the Intermediate Level.



Aaron Pioveson is participating in Day Release for Trade School to conclude in May 2010.

Jasper Degroot and **Earle Thompson** successfully completed the **St. John's Ambulance Course** in October.



Electrical Safety

Across

1. Isolation of circuit
3. Safety glasses are used for _____ protection
4. F.R. stands for _____ Resistant
5. P.P.E. stands for _____ Protective Equipment

Down

2. OSHA stands for _____ Safety Act
3. Short circuit through air

